

Finding the Numbers...

On most appliances, the Make, Model and Serial numbers can be found rather easily. The following instructions fit most makes and models.

Refrigerators:

Look just inside the main cabinet door of the refrigerator. Either on the ceiling or sidewall you will find the manufacturer's decal of information. Higher-end units with compressors on top have removable grills with data plates behind them. Some older model refrigerators have a data name plate at the bottom frame near the hinges.

Dishwashers:

Nearly all makes and models have the data plate or decal inside the tub frame or on the edge of the door.

Disposals:

The decal will be on the cylinder or on the bottom in most cases.

Ranges, Ovens, and Cook tops:

Open the oven doors and look around the frames for data plates. Sometimes they are hidden behind the control panel. Use a mirror to get a better look. Cook tops can be tricky; remove burner covers on some models and others have the data plate under the unit which means you might have to stand on your head to see them inside the cabinet.

Microwaves and Other Appliances:

Generally located inside the appliance or labeled on the surface.

Water Heaters:

All water heaters have a data plate on the front of them. There is more information than you need to collect, so make sure of what you are writing down.

Air Conditioners and Heat Pumps:

The inside units have data plates right on the covers. The outside units are also somewhere on the cabinets themselves. You will find that the weather has worn away the numbers and it will be difficult to do a RecallChek on that appliance. In such cases, enter "None Found" in the Model number field.

- ▶ Locations for model number tags for refrigerators vary, but are generally accessible and easy to find.

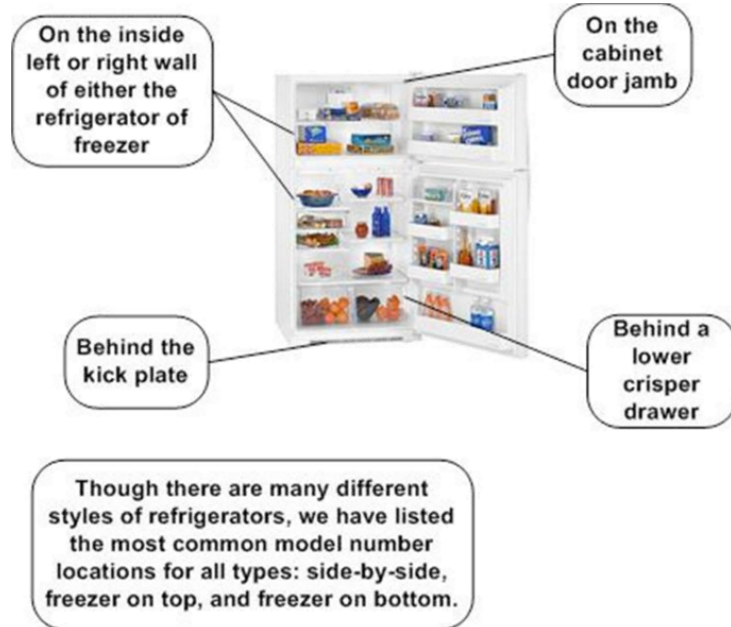

RecallChek®

RWS Inspector Services Group
800-544-8156

27

- ▶ Slide-in / Drop-in Stoves are usually more difficult to deal with.
- ▶ Remember: If it isn't within the scope of the inspection, don't report it- just list the oven/stove without the model number but with the make.

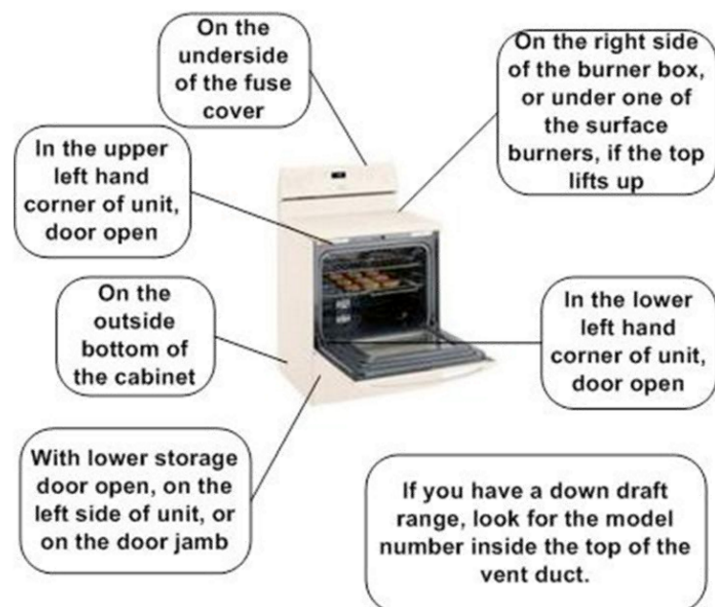

RecallChek®

RWS Inspector Services Group
800-544-8156

28

- ▶ Dishwasher tags are usually on the door or the door frame.

